

Meeting Rooms & Offices for Rental during CoP15

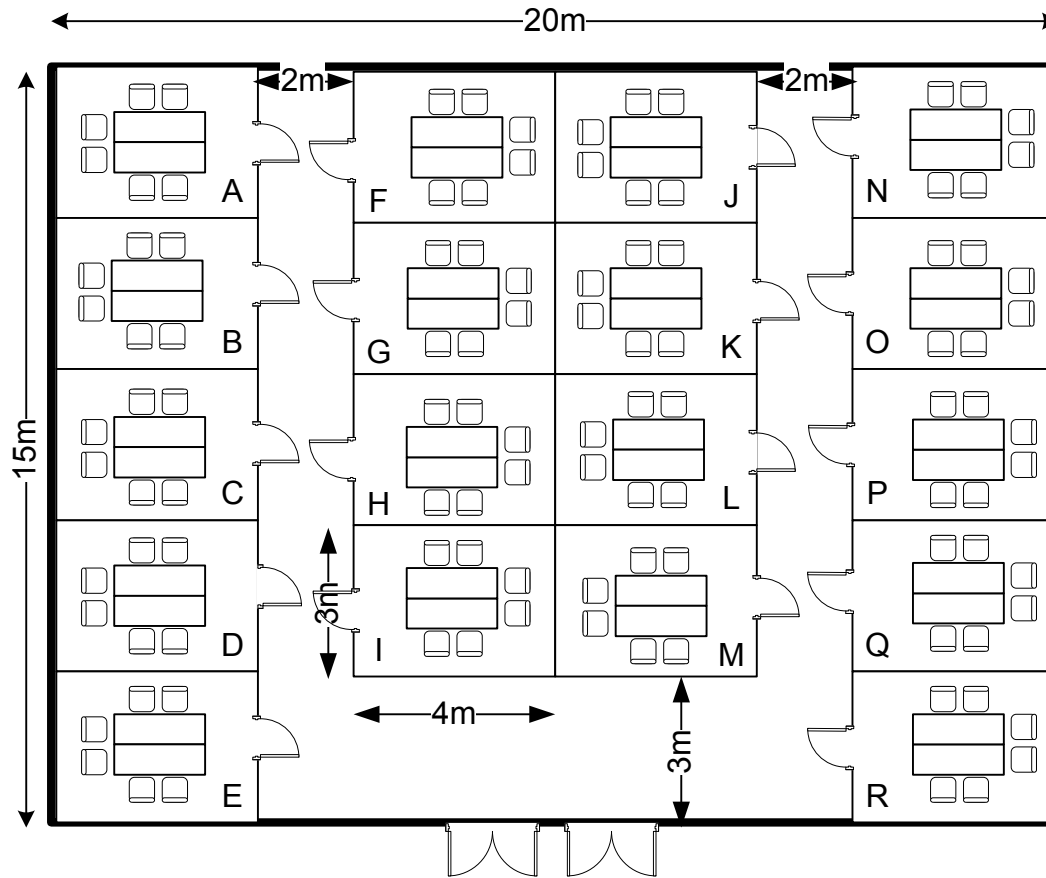

Office Space Layout A – R

- A: 4m x 3m (12sqm)
- B: 4m x 3m (12sqm)
- C: 4m x 3m (12sqm)
- D: 4m x 3m (12sqm)
- E: 4m x 3m (12sqm)
- F: 4m x 3m (12sqm)
- G: 4m x 3m (12sqm)
- H: 4m x 3m (12sqm)
- I: 4m x 3m (12sqm)
- J: 4m x 3m (12sqm)
- K: 4m x 3m (12sqm)
- L: 4m x 3m (12sqm)
- M: 4m x 3m (12sqm)
- N: 4m x 3m (12sqm)
- O: 4m x 3m (12sqm)
- P: 4m x 3m (12sqm)
- Q: 4m x 3m (12sqm)
- R: 4m x 3m (12sqm)

**Logistics per Room:**  
 2 x Tables (0.6m x 1.8m)  
 6 Chairs: (0.6m x 0.6m)  
 2 x 13amp points

**Notes:** Each room has pre-fabricated walls, one door and Fabric-ceiling. Rooms can be combined

Event:  
CITES 2010

Drawing Title:  
Meeting Rooms & Offices  
for Rent during CoP15

Location:  
Sheraton Hotel,  
Convention Center

Date:  
24/11/09